

SAFETY AND CARE ADVICE

Important - Please read these instructions fully before starting assembly

- Check you have all the components and tools listed on pages 2 and 3.
- Remove all fittings from the plastic bags and separate them into their groups.
- Keep children and animals away from the work area, small parts could choke if swallowed.
- Make sure you have enough space to layout the parts before starting.
- Do not stand or put weight on the product during assembly, this could cause damage.
- Assemble the item as close to its final position (in the same room) as possible.
- Assemble on a soft level surface to avoid damaging the unit or your floor.
- Parts of the assembly will be easier with 2 people.



• We do not recommend the use of power drill/drivers **for inserting screws**, as this could damage the unit. Only use hand screwdrivers.

- Dispose of all packaging carefully and responsibly.

Care and maintenance

- Only clean using a damp cloth and mild detergent, do not use bleach or abrasive cleaners.
- From time to time check that there are no loose screws on this unit.
- Do not stand on the chair.
- Do not use this chair as step ladder.
- This product should not be discarded with household waste. Take to your local authority waste disposal centre.

Handy Hints

- Assemble all parts and bolts loosely during assembly, only once the product is complete should you fully tighten the bolts.
- Regularly check and ensure that all bolts and fittings are tightened properly.

Concept Deluxe

Assembly instruction - Please keep for future references

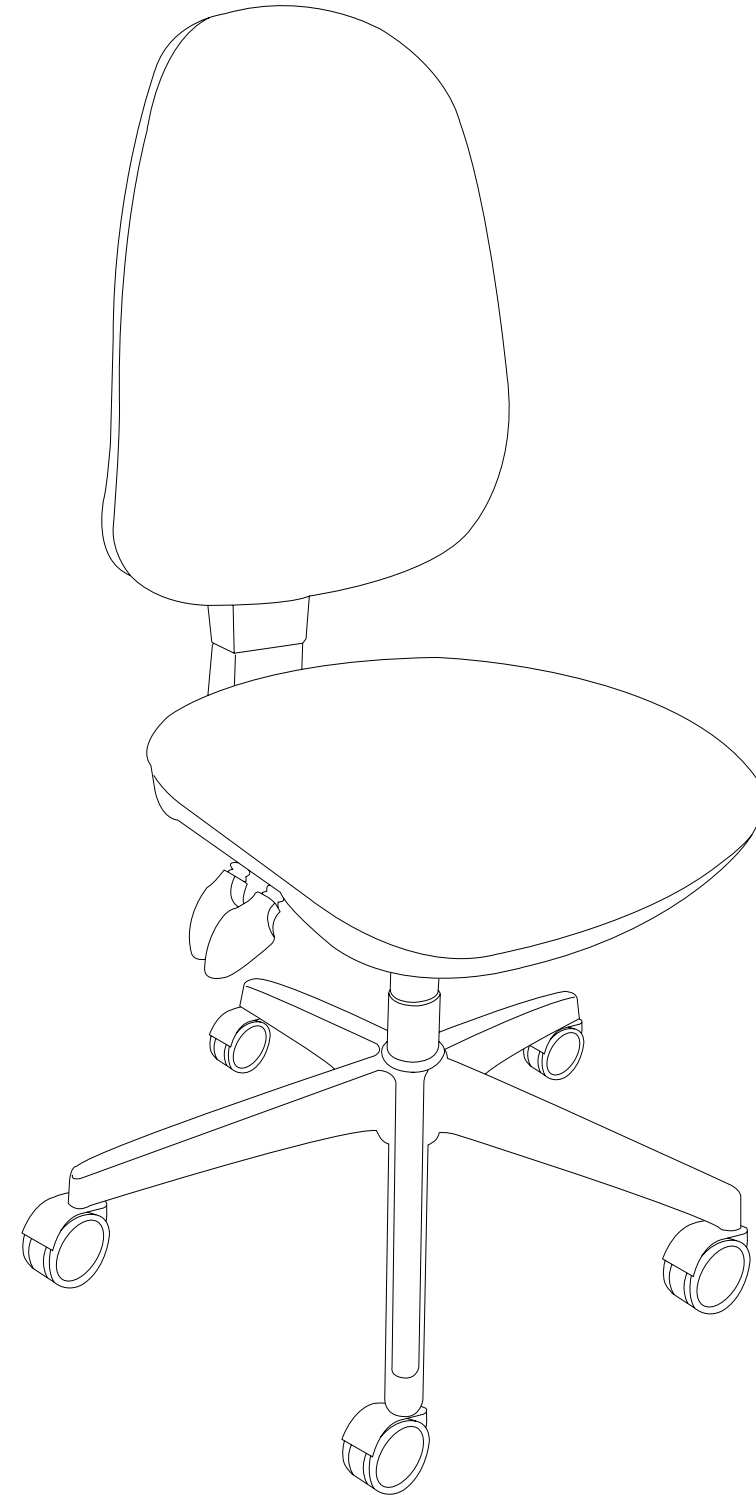

IMPORTANT - PLEASE READ THE INSTRUCTION FULLY BEFORE STARTING ASSEMBLY

COMPONENTS - PARTS

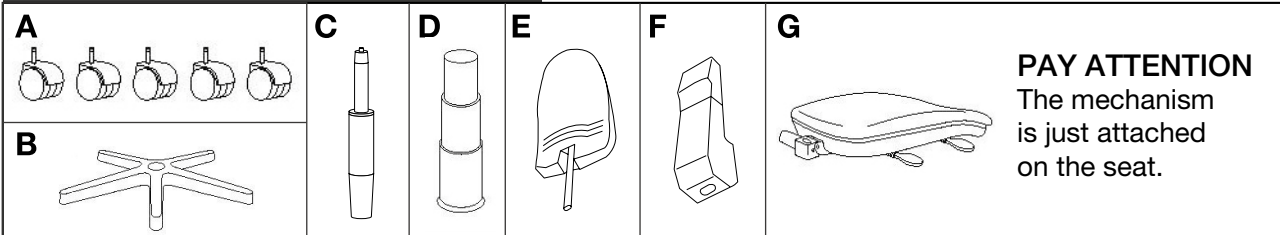

COMPONENTS - FIXING

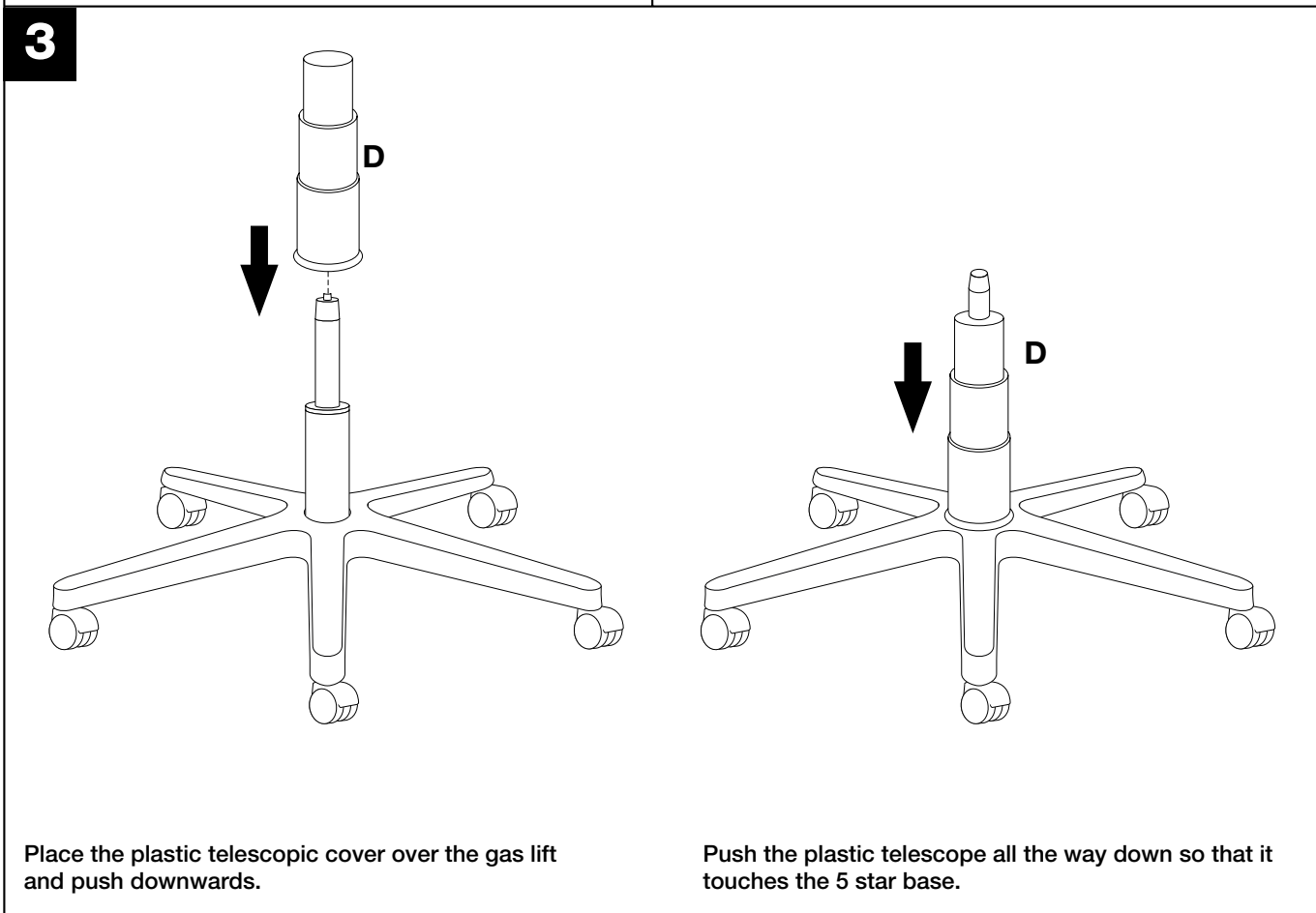
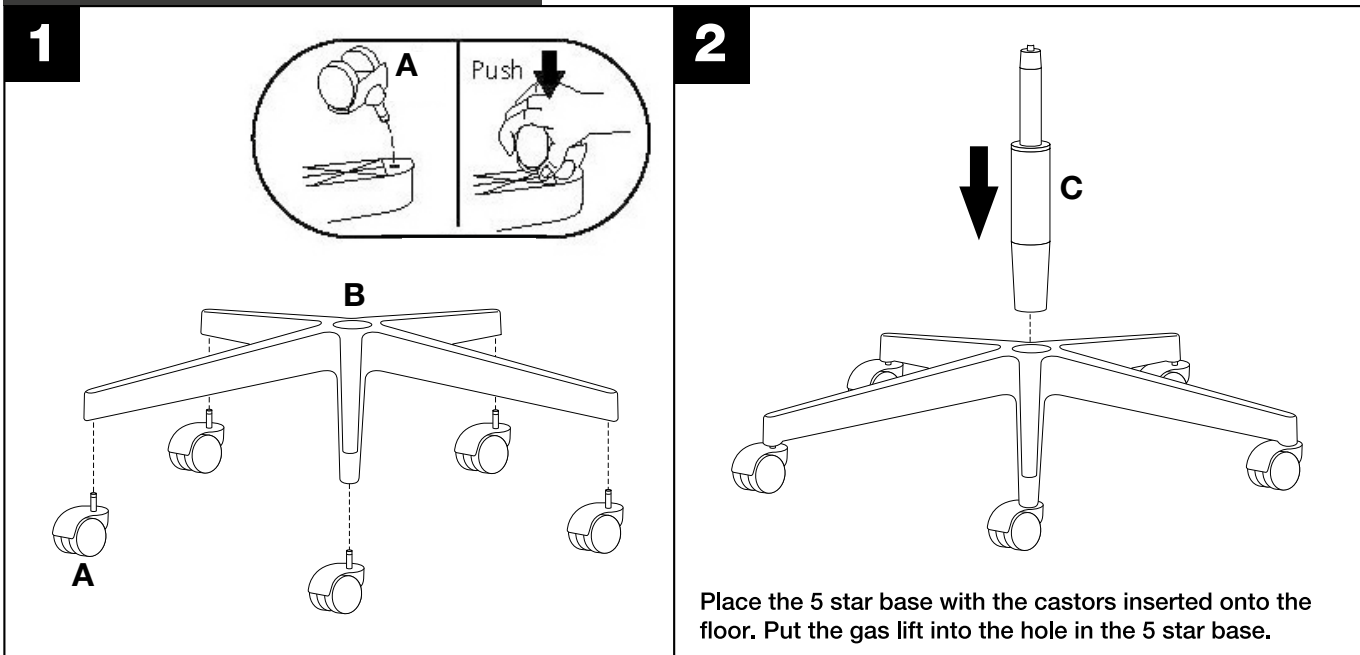

ASSEMBLY INSTRUCTIONS

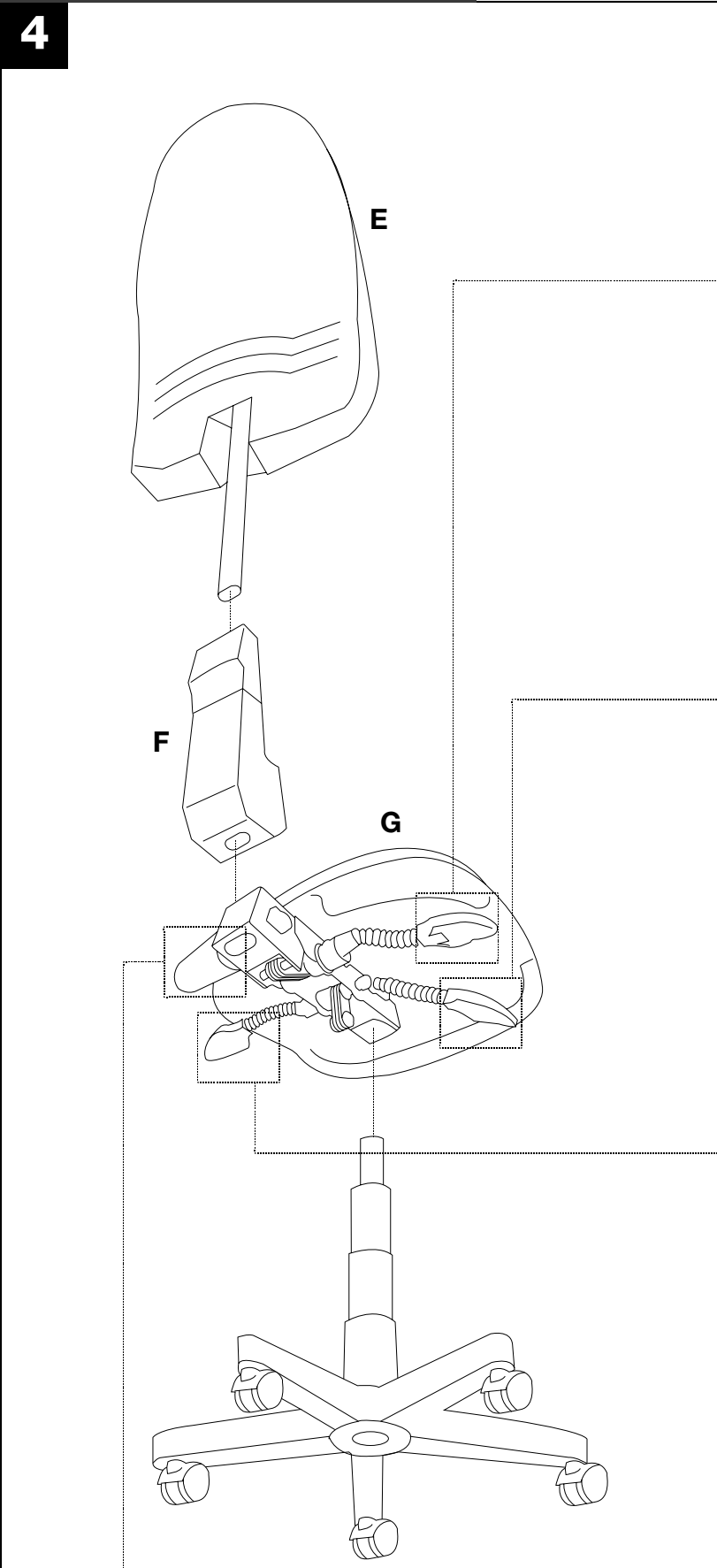

OPERATING INSTRUCTIONS

BACK INCLINATION ADJUSTMENT
ON SYNCRO TIL THIS LEVER IS THE SYNCRONISED BACK AND SEAT TILT

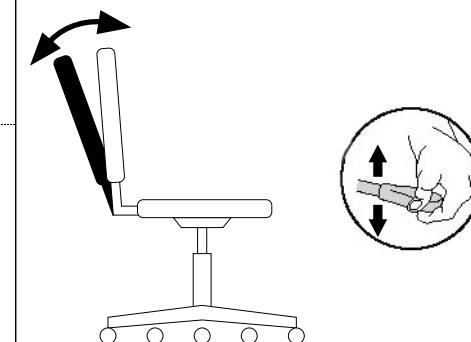

SEAT HEIGHT REGULATION

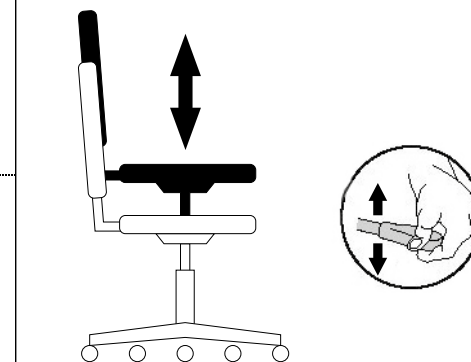

SEAT INCLINATION ADJUSTMENT
SEAT TILT ONLY AVAILABLE ON:
CONCEPT MAXI TILT AND CONCEPT DELUXE

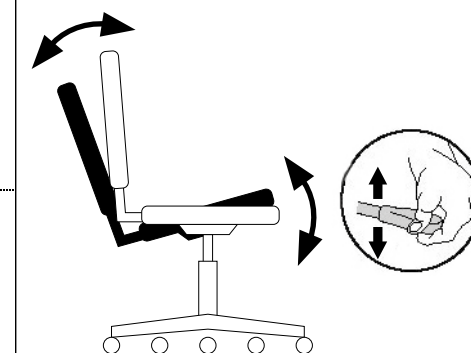

BACK HEIGHT REGULATION

- 1-Turn the knob counterclockwise for unlock the mechanism and insert the back.
- 2-Up and down the back and choose the favourite position.
- 3-Turn the knob clockwise for lock the back.

